

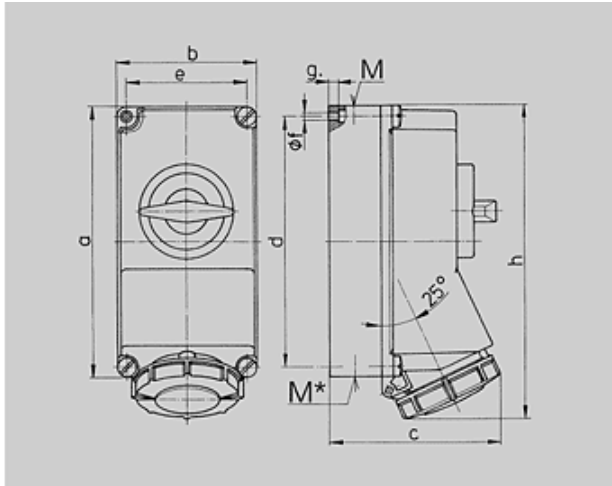

N° de Ref. : 5605A

Base

con interruptor y enclavamiento mecánico DUO



Plano	Amp.	16			32		
		Polos			3	4	5
Dim. en mm	a	225	225	225	225	225	225
	b	118	118	118	118	118	118
	c	144	146	147	152	152	153
	d	208	208	208	208	208	208
	e	101	101	101	101	101	101
	f	6,3	6,3	6,3	6,3	6,3	6,3
	g	8	8	8	8	8	8
	h	252	255	259	268	268	274
	M	1xM25 y 1xM32		1xM25 y 1xM32		1xM25 y 1xM32	
	M*	2x25	2x25	2x25	2x25	2x25	2x25
	Diám. máx. de cable (mm)	25	25	25	25	25	25
	Borna para cond. Sección Transvers. (mm ²) min.-max.	1,5	1,5	1,5	2,5	2,5	2,5
		-4	-4	-4	-10	-10	-10

 Grupo de artículos : **1074**

voltages : 400V

rated current : 32A

pole : 4 pole







SCHUKO IP protection types : IP67

position of ground contact : 6h

packing unit : 0001

Peso : 1210 g

N° DE REF.

	V	110V	230V	400V	500V	>50-500V	
		50,60	50,60	50,60	50,60	100-300	300-500
Color código							
Amperios							
16 A	3	7011A	7012A				
	4		5599A	5600A	5601A		
	5		5602A	5603A			
32 A	3	5924A	5793A				
	4		5604A	5605A	5606A		
	5		5607A	5608A			