

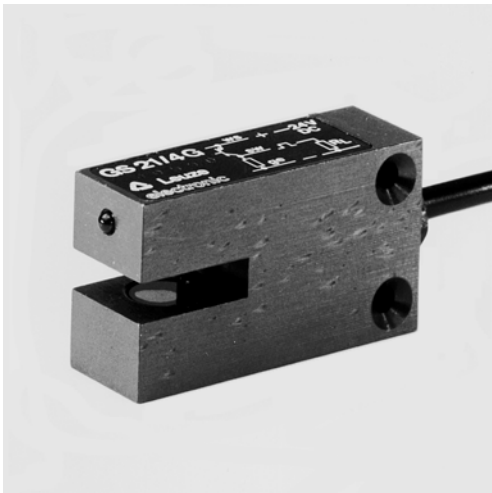

GS 21

Forked photoelectric sensors



Dimensioned drawing

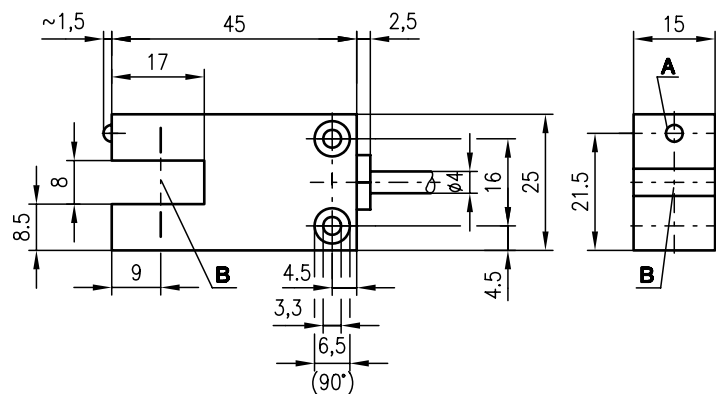

A Indicator diode
B Optical axis



8mm



- GaAs top photoelectric sensor in constant light operation with gallium arsenide transmitter diode ensures a long lifetime
• Fast amplifier with high switching frequency for detection of short events (e.g. gaps between labels)
• Transistor output - separate switching amplifier not required
• Insensitive to interference due to low impedance output
• Indicator diode displays the switching state

Electrical connection

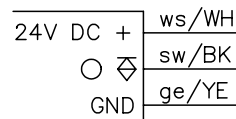

Accessories:

We reserve the right to make changes • GS\_a13e.fm



### Specifications

<b>Optical data</b>	
Mouth width	8mm
<b>Timing</b>	
Switching frequency	1000Hz
Response time	0.5ms
<b>Electrical data</b>	
Operating voltage $U_B$ <sup>1)</sup>	24VDC, filtered $\pm 10\%$
Residual ripple	$\leq 15\%$ of $U_B$
Bias current	$\leq 90mA$
Switching output	1 PNP transistor output
Function characteristics	light switching
Signal voltage high/low	$\geq (U_B - 2V) / \leq 2V$
Output current	100mA
<b>Indicators</b>	
LED red	light path free
<b>Mechanical data</b>	
Housing	aluminium, anodised
Weight	120g
Connection type	cable 5000mm (cross section 3x0.25mm <sup>2</sup> )
<b>Environmental data</b>	
Ambient temp. (operation/storage)	-20°C ... +60°C / -30°C ... +70°C
Protective circuit <sup>2)</sup>	1, 2
VDE safety class	III
Protection class	IP 65

1) Functional extra-low voltage with reliable disconnection or protective extra-low voltage (VDE 0100/T 410)  
 2) 1=polarity reversal protection, 2=short-circuit protection for all outputs

### Tables

### Diagrams

### Order guide

Designation	Part No.
GS 21/4 G	500 13967

### Remarks